



Lom National Park Village

– where nature meets culture

The centre of Lom, Fossbergom, is one of five national park villages in Norway. It is a natural gateway to the national parks Jotunheimen, Reinheimen and Brehheimen. In summer Fossbergom swarms with villagers and tourists. We can offer our guests a pleasant atmosphere with open air restaurants, cafes, shops, an accomplished architecture and many great tour options.



Welcome to Lom National Park Village!



1 Lom Slave Church
Lom Slave Church is one of the largest of its kind in Norway and dates back to 1158-59. It is still the main church in Lom. Guiding in May – September (outside the season should be booked).



2 Loar
The old vicarage in Lom was situated here. Today you can find Lom Library, Slave Church Centre and a convent shop with local produce in Loar ("Loarutsaliget").



3 Steinfoset
Steinfoset (a cowshed) is one of its kind. Steinfoset is currently used as a gym for elementary school and as an exhibition hall in summer.



4 Storstaburet
Storstaburet is built in 1613, and is the biggest store house in Norway. Inside, you can find an exhibition about the old irrigation culture in the villages of Ottadalen valley.



5 Lom Rural Museum – Presthaugen
Lom Rural Museum is situated in Presthaugen, which is also a meeting place in Lom. It is an open air museum with 22 protected buildings from the period of 1613 – 1900. A marked path goes around Presthaugen.

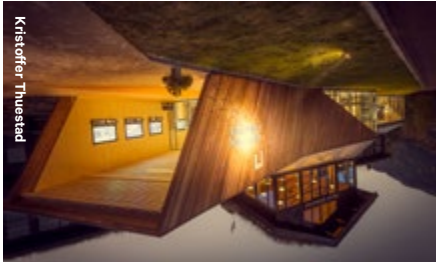

6 The Norwegian Mountain Center
Enjoy exhibitions and find information on how to best explore the area at the Norwegian Mountain Center! Located in the centre of Lom, this is also a national park visitor centre for Jotunheimen, Reinheimen, and Brehheimen. In the shop, you will find maps, mountain-related books for children and adults, local handicraft, and souvenirs.



7 Prestfosstravresen
Prestfosstravresen (zipline) was established in 2009, and has become a popular activity for not only young people, but older as well. The zipline runs over the mighty Prestfossen in the middle of Fossbergom, right under the Ulstad bridge. Contact Aktiv i Lom for more information.



8 Ulstadbrua Bridge
The Ulstad Bridge flows from the highest points of Jotunheimen. The volume of water varies throughout the year from 1 m3 to 300 m3/sec during the biggest floods. There was a sawmill and a mill on Prestfossen Waterfall, and one of the first water power plants in Norway was put into operation in the early 1920s.



9 Bakery in Lom
The Bakery was established by master chef and baker Morten Schakenha, and is one of the most famous bakeries in Norway. Other places offering food services are Brimblin, Sentra, Amore, Fossberg, Fossheim, Nordal, Esso, Best and Smak i Lom.



11 Tor Jonsson memorial
The rock is a memorial to the famous Norwegian poet Tor Jonsson (1916 – 1951), who grew up in Lom. Tor Jonsson committed suicide in 1951, and got the Norwegian Critics Prize for Literature post mortem.



12 Fossheim Hotell
Member of "The Historic Hotels and Restaurants", Fossheim has a cuisine where the food is cooked of ingredients from local farms, rivers, lakes, and mountains. Fossheim Centre are all family businesses with more than 100 years of history, run by the same families.



13 Time Axis
The Time Axis follows Bergsmunda walk (marked with a white stipple line), and gives you an insight into Earth's 4600 million years old history.



14 Fossheim Stone Centre
The Geological Museum has the biggest private exhibition of Norwegian gemstones and minerals in Norway. The Centre includes a gallery, jewelry shop and workshop, where you can get help in choosing a gem.



15 Lomsengen Activity Park
Lom is a place for active people. Here you can find a climbing tower, and several free activity devices. If you want to use the tower, ask staff at Aktiv i Lom.



16 Utlegsbua log bridge
The bridge is constructed as a log bridge from 18th century. It is a modernised version of the oldest bridge constructions we know and logs laid across a river. The bridge was built in cooperation between "Stokk & Stein" company and carpentry students from Lom.



17 Andvardsbrua Bridge
The footbridge by Lom Camping was officially opened in June 2016 and is a part of the Bergsmunda walk. The bridge connects the trail on both sides of the Bøvre River. It is a good starting point for hikes to Lomsengen Peak, Bordvassvegen and Læshø Peak.